

Fact Sheet

ICP

BIZERBA

Multi-functional device for strip cutting and tenderizing of meat also for industrial continuous operation. Perfect all-round protection and easy handling allow fatigue-free operation. Perfectly suitable for daily use also in the gastronomy business.



More information
High performance
with a wide range of
solutions and options.

Specifications	Facts	Details
Dimensions		
Outer dimensions L x W x H	351 x 410 x 456 mm	Standard model
	351 x 410 x 481 mm	Model with feed pan
	452 x 410 x 490 mm	Model with feeder chute
Installation area L x W	260 x 345 mm	Standard model, model with feed pan and model with feeder chute
Work area L x W x H	378 x 410 x 473 mm	Standard model
	378 x 410 x 511 mm	Model with feed pan
	452 x 410 x 574 mm	Model with feeder chute
Electrical data		
Power consumption	100-120 V; 50/60 Hz; 2.3 A	1-phase alternating current with Emotion®
	220-240 V; 50/60 Hz; 1.0 A	1-phase alternating current with Emotion®
IP rating	IP33	
Performance data		
Product size		
Quadratic W x L	180 x 30 mm	
Blade roller speed	100 rpm	
Housing material	Stainless steel	
	Plastics	
Weight		
Machine weight	approx. 33 kg	
Cutting insert	approx. 6 kg	
Packaging data		
Dimensions L x W x H	740 x 570 x 460 mm	Basic unit
	300 x 200 x 250 mm	Cutting insert
Packaging weight	approx. 36.5 kg	Basic unit
	approx. 6.5 kg	Cutting insert
Options		
Infeed and discharge combs		Feeding of products up to 30 mm thick
Knitting (S012)		Joining meat pieces
Tenderizing (S011)		Reduces the toughness also for marinating
Strip cutting (S021)	3, 4, 6, 8, 10, 12 and 20 mm	

Info graphics



Symbols



Dimensional drawings

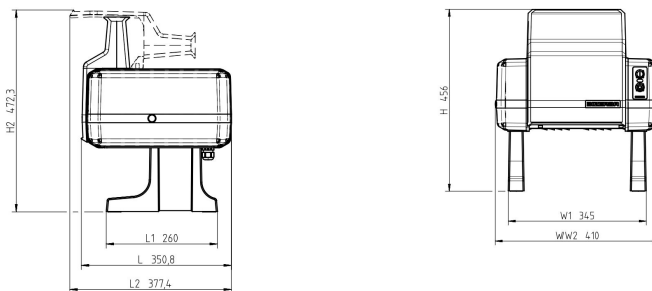

ICP standard model

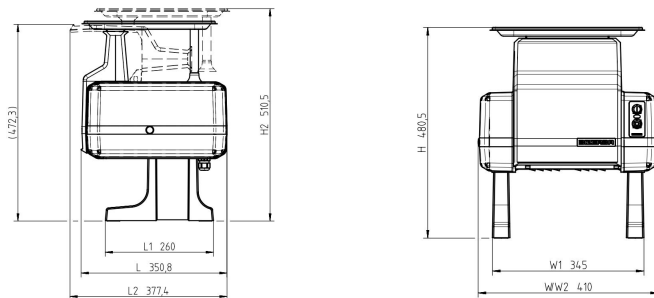

ICP with feed pan

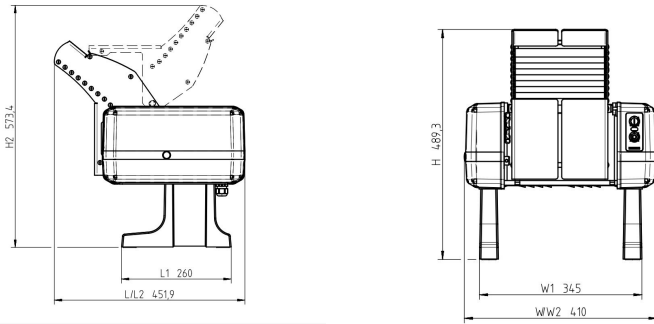

ICP with feeder chute

Bizerba SE & Co. KG
Wilhelm-Kraut-Straße 65
72336 Balingen

T +49 7433 12-0
fax: +49 7433 12-2696
marketing@bizerba.com

www.bizerba.com